

POWER STEERING OIL PUMP (ZJ, Z6) REMOVAL/INSTALLATION

B3E061432650W01

1. Remove the under cover and splash shield.
2. Remove the drive belt. (See [DRIVE BELT REPLACEMENT \[ZJ, Z6\]](#).)
3. Remove in the order indicated in the table.
4. Install in the reverse order of removal.

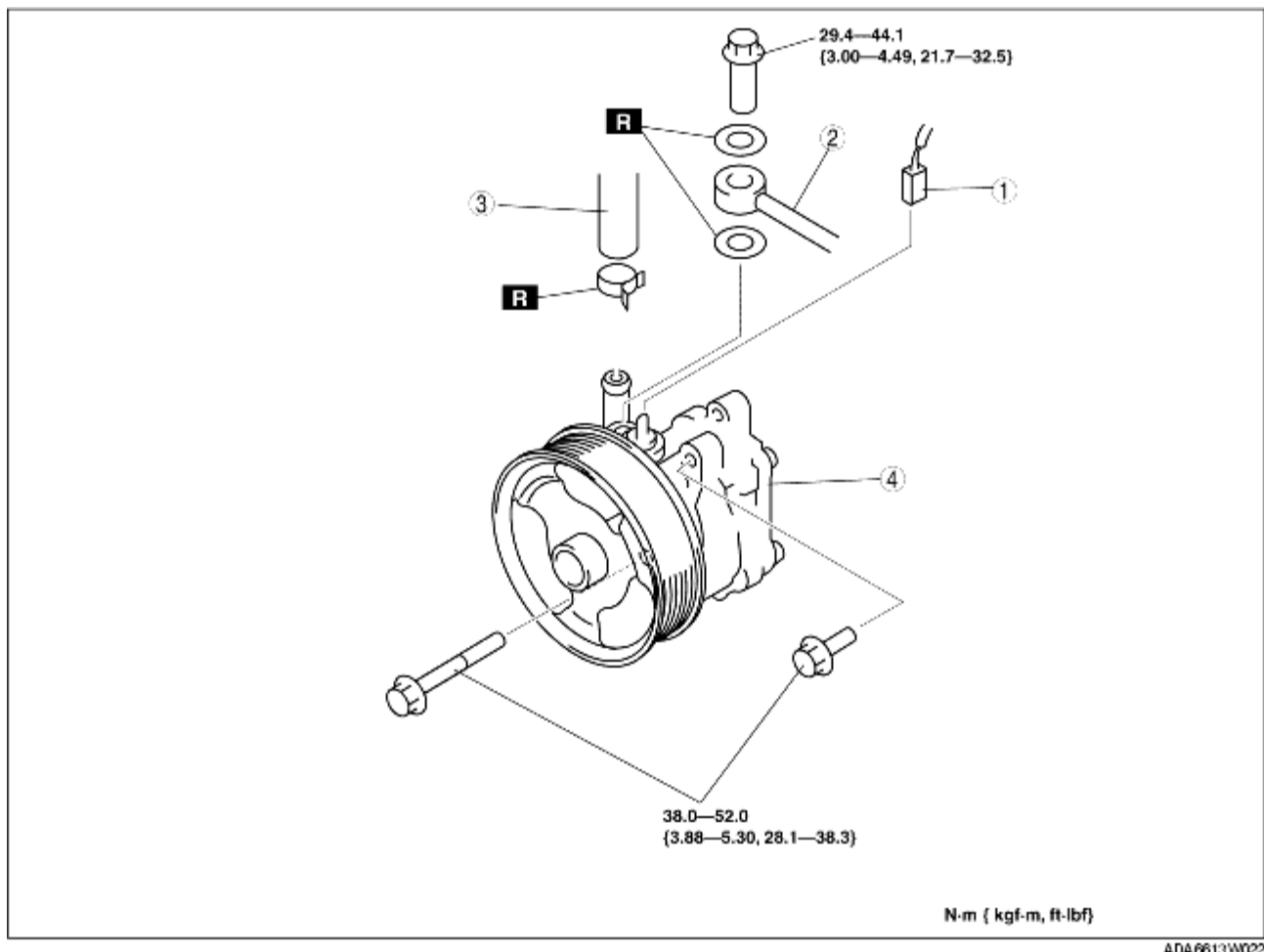

ADA6613W022

1	Pressure switch connector
2	Pressure pipe
3	Suction hose
4	Power steering oil pump